



Magma
9918 Via Pasar, San Diego, CA 92126, USA
Phone (800) 285-8990 US, (858) 530-2511 • Fax (858) 530-2733

www.magma.com

© 2008 MissionTechnology Group, Incorporated, DBA Magma
This publication is protected by Federal Copyright Law, with all rights reserved. No part of this publication may be copied, photocopied, reproduced, stored in a retrieval system, translated, transmitted or transcribed, in any form or by any means manual, electric, electronic, electro-magnetic, mechanical, optical or otherwise, in whole or in part without prior written consent from MissionTechnology Group, Inc..

Limitation of Liability
Information presented by Magma in this manual is believed to be accurate and reliable. However, Magma assumes no responsibility for its use. No license is granted by implication or otherwise to any rights of Magma.

Trademark References
Trademarks and registered trademarks are proprietary to their respective manufacturers.

Product specifications and prices are subject to change without notice.

09-09974-01

Quick Installation Guide

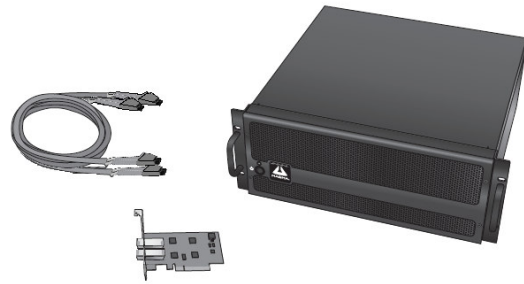

Magma EF6

Package Contents

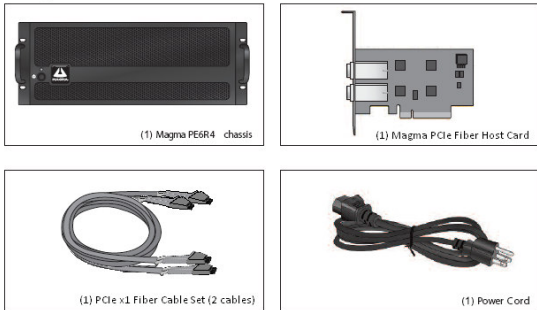

1 IMPORTANT
Important safety, ESD, and other information on how to use Magma PE6R4 are provided in the User Guide. This manual is available online for a download at www.magma.com/support/manuals.

Electrostatic Discharge Warning (ESD)
Perform installation and service of circuit cards with semiconductor devices at an ESD work station and follow proper ESD procedure to reduce the risk of damage to components.

1 Install PCI Express Host card and connect cables

Install the Magma PCI Express Host Card into an available PCI Express slot in your computer.

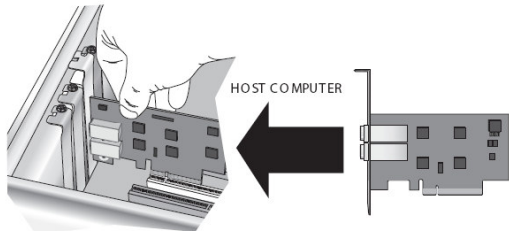

Secure it with retaining screw.

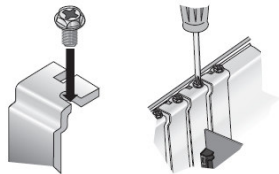

Connect the CLK fiber cable and the DATA fiber cable to the host card. Make sure the fiber transceivers are installed in the cages.

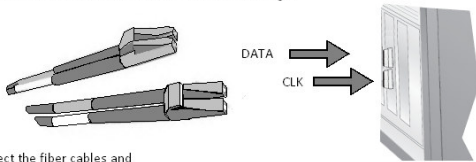

Connect the fiber cables and the power cord to the back of the chassis as shown.

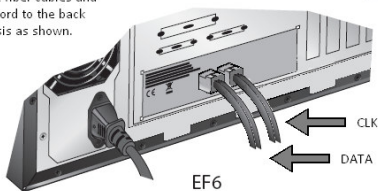

2 Open Enclosure

Remove the 6 screws that retain the top cover of the expansion chassis.

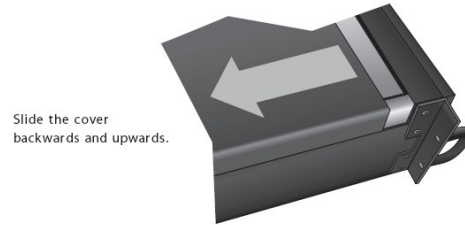
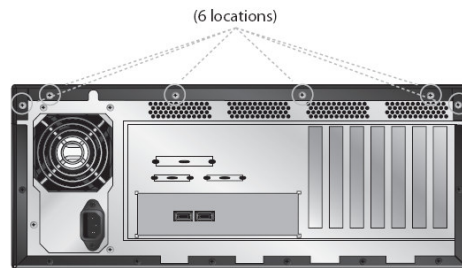

Slide the cover backwards and upwards.

3 Install PCI or PCI-X cards

Remove PCI filler brackets for the expansion slot you wish to use in the chassis. Install peripheral PCI or PCI-X card into slot connector and secure with retaining screw.

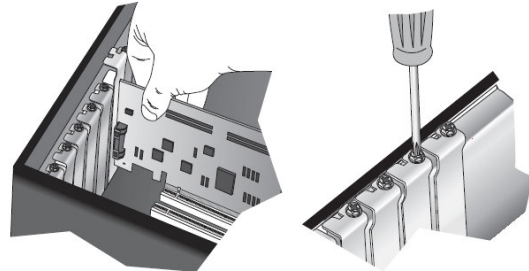

Repeat the process for all other PCI or PCI-X peripherals you wish to install in the chassis.

4 Power on EF6

Turn the power on using the power switch on the front of the chassis. Verify that the green LED above the power switch is on.

